

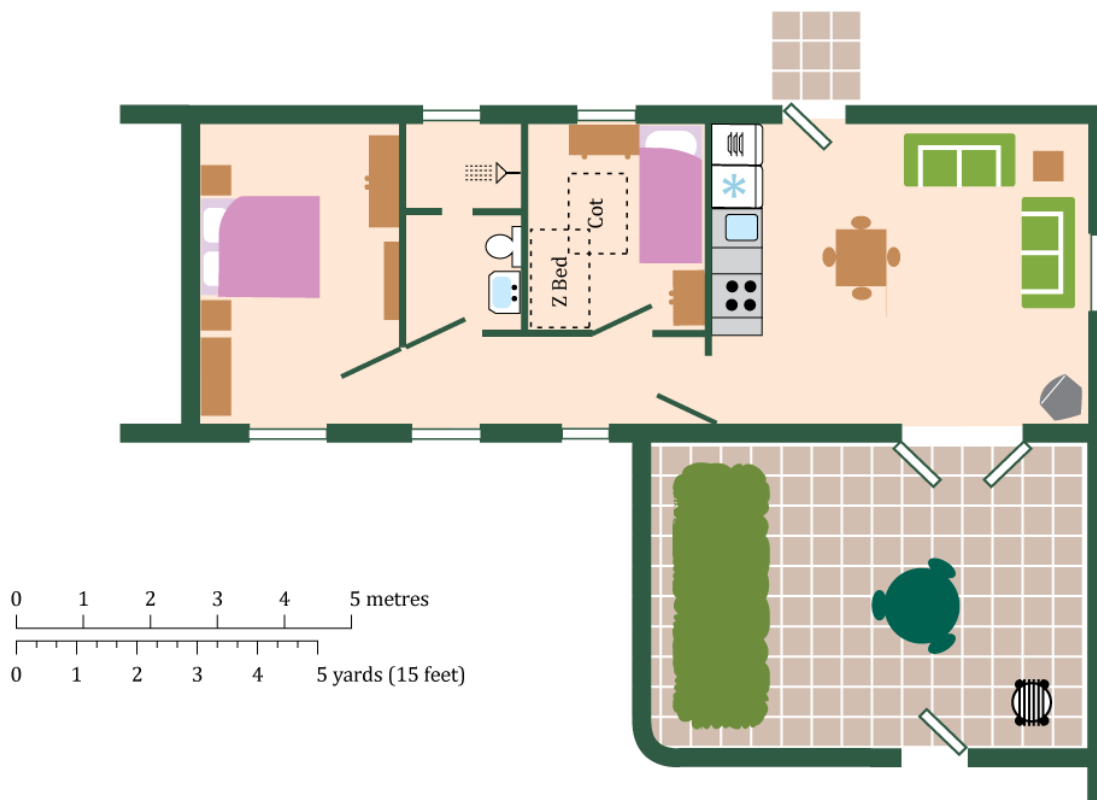

## Coot Cottage – Sleeps 3 + wooden cot/Z bed

- Double bedroom Super-king-sized bed (6ft Zip and link beds) - space for travel cot
- Single bedroom – 3ft single bed - space for Wooden cot or travel cot or z bed for a child or 2 travel cots.
- Kitchen & living room – Stone floors/underfloor heating throughout cottage
- Bathroom with spacious walk-in shower & WC
- Adjacent to car park
- Sorry no pets allowed
- Suitable for those with limited mobility please see access statement or call us to discuss your requirements



### Your cottage includes:

- You will find a Welcome information folder in your cottage
- Hypo-allergenic duvets & pillows
- Linen (duvets), towels, tea towels, oven gloves.
- Electricity from our green energy sources with mains back-up

- Under floor Heating from Ground Source heat pump, solar water system (LPG boiler back up)
- Flat screen TV with Freeview & DVD
- I Pod docking station
- Selection of books & games
- Wireless Broadband Internet connection & wired LAN access point.
- Fully equipped kitchen with cookware, serving dishes, cutlery, crockery & glassware
- Plastic bowls & cups for kids
- Salt & pepper
- Cafetiere, toaster, hand blender, mini whisk
- Gas/ electric range cooker.
- Microwave, dishwasher, fridge/freezer
- Ice cube trays, storage boxes.
- Iron, ironing board, hairdryer, clothes line, pegs
- Torch, matches, tea light candles
- BBQ, garden furniture
- Private walled terrace
- **Highchair, wooden cot, travel cot, bed guards, baby bath, Blackout blinds on request\* (single bedroom is north facing)**

Laundry: 24-hour laundry access, tumble driers available.

### **Water onsite at Cranmer**

Water is supplied from our deep borehole. We are in a hard water area. Drinking water available from the kitchen cold water taps which is filtered at source and tested according to the UK drinking water quality regulations. Water to the shower and washing machine is softened with an ion exchange water softening system.

- Babies under 6 months should only drink bottled water.
- Formula milk should also be made with bottled water.
- Evian and Highland spring are low sodium mineral waters



**Eco Friendly Housekeeping starter box is located under your kitchen sink:**

- Delphis multi-purpose cleaner
- Delphis sanitiser spray
- Delphis Washing up liquid
- Delphis washroom cleaner
- Dishwasher tabs
- Laundry tablets
- Toilet roll per bathroom
- 2 black sacks

You may require further supplies for the duration of your stay.

### **Extras and special requirements**

Please email us at [bookings@norfolk-luxury-cottages.co.uk](mailto:bookings@norfolk-luxury-cottages.co.uk) if you require any additional extras or to make any special arrangements at least two weeks prior to your stay.

Please request if you have not already:

- Highchair, travel cot, bed guards, baby bath, blackout blinds
- Bikes can be safely stowed request lockable bike shed key
- Key Safe: For arrivals after 6.00pm your front door key is available from the safe adjacent to the entrance of your cottage. You must contact us to advise a late arrival and we will supply the box code

#### **Please bring with you:**

- Towels for the swimming pool
- Infants must wear a Splashabout neoprene Happy Nappy you can purchase these at [www.splashabout.com](http://www.splashabout.com)
- Cot mattress and cot linen we do not provide these. Cot size

#### **Supermarket deliveries**

When ordering your supermarket delivery from Waitrose, Sainsbury's or Tesco. **Please supply the COTTAGE NAME** and arrange for your delivery to arrive after you have, as we do not have staff to stow or check the order. Thank you.



#### **Waste management at Cranmer Country Cottages**

We are in a rural location and we are not on mains drainage. **We ask our guests not to put anything down the toilet other than toilet paper.** Baby wipes, makeup wipes, personal hygiene and nappies should all go in general/ household rubbish – not recycling even if they do say they are biodegradable! Wipes block our drainage system which can result in non-flushing loos in your cottage.

We provide a waste sorting area behind the Fat lady petrol pump adjacent to the main parking area opposite to the main courtyard entrance. There are 3 bins: General/household waste – goes to landfill, Recycling bin & glass recycling bin.

Please consider the environment by putting your rubbish in the correct bins.

Our waste carriers require us to sort:

**Household waste** – all foodstuffs & food packaging with traces of food, tea bags, vegetables, nappies, wipes soft plastic packaging crisps and sweet wrappers.

**Recycling** – clean, rinsed out food & drink cans & cartons, clean pots & tubs, plastic bottles – milk, drinks, shampoo. Cardboard, paper, envelopes newspapers, clean aluminium foil & trays.

Please rinse out containers and place loosely in the recycling bin (not in plastic bags)

If food waste or dirty items or soft plastics go into the recycling the whole bin becomes contaminated and all waste goes to landfill!